



# State of New York County of Broome Government Offices

---

Department of Public Works – Engineering Division

Jason T. Garnar - County Executive · Roger V. Brown, PE – Commissioner of DPW

April 29, 2026

Deborah Proffitt, Town of Sanford Clerk  
91 Second Street  
Deposit, NY 13754

RE: Certificate of Road Closure  
Old Route 17 (CR 28)

Ms. Proffitt,

This notice is to inform you that per Section 104, of the New York State Highway Law, Broome County is filing the enclosed Certificate of Highway Closure to accommodate the replacement of a large cross culvert. The road closure is scheduled to begin on Monday, May 11, 2026, at 7:00 a.m. and end on or about Saturday, August 15, 2026, at 5:00 p.m.

All thru traffic will need to seek alternate routes while the road is closed. A signed detour route will be in place during the closure.

If you have any questions or concerns regarding this scheduled road closure, please feel free to contact Marty Haley, by calling the Broome County Department of Public Works – Engineering Division at (607) 778-2463, or by emailing him at [Martin.Haley@BroomeCountyNY.gov](mailto:Martin.Haley@BroomeCountyNY.gov).

Sincerely,

Roger V. Brown, P.E.  
Commissioner of Public Works

RVB/mfh

Enclosure: Certificate of Road Closure



State of New York  
County of Broome Government Offices

---

Department of Public Works

Jason T. Garnar, County Executive · Roger V. Brown, PE – Commissioner of DPW

CERTIFICATE OF HIGHWAY CLOSURE

OLD ROUTE 17 – COUNTY ROAD 28

TOWN OF SANFORD

MAY 11, 2026 – AUGUST 15, 2026

ROGER V. BROWN, P.E., COMMISSIONER OF PUBLIC WORKS

This CERTIFICATE OF HIGHWAY CLOSURE shall continue to meet the requirements of Section 104 of the New York State Highway Law. Old Route 17, a County owned road located in the Town of Sanford, shall be closed to all traffic on May 11, 2026, at 7:00 AM and reopened to traffic on or about 5:00 PM August 15, 2026. The approximate closure location will be 1994 Old Route 17 or at the intersection of Mt View Drive and Old Route 17. The road will be closed for a large culvert replacement.

All thru traffic will need to seek alternate routes while the road is closed; A signed detour will be in place.

Additional information may be obtained by contacting Marty Haley, Engineer I at (607) 778-2463, or emailing him at [Martin.Haley@BroomeCountyNY.gov](mailto:Martin.Haley@BroomeCountyNY.gov), Broome County Department of Public Works.

ROGER V. BROWN, P.E.  
COMMISSIONER OF PUBLIC WORKS

FILE NAME = I:\Projects\2007287 - Broome County\287.020 - Old Route 17\287.020-WZTC-2.dgn  
 DATE = 3/19/2025  
 TIME = 3:40:28 PM

MicroStation\Bentley\_V8\Workspace\Plot\WYSDOT\_SIZE\_B\_XEROX.tbl  
 MicroStation\Bentley\_V8\Workspace\System\plot.ctb

IN CHARGE OF WRB  
 DESIGNED BY GRW/KTR  
 CHECKED BY WRB  
 DRAFTED BY WRB  
 MEK/KTR  
 CHECKED BY WRB/GRW

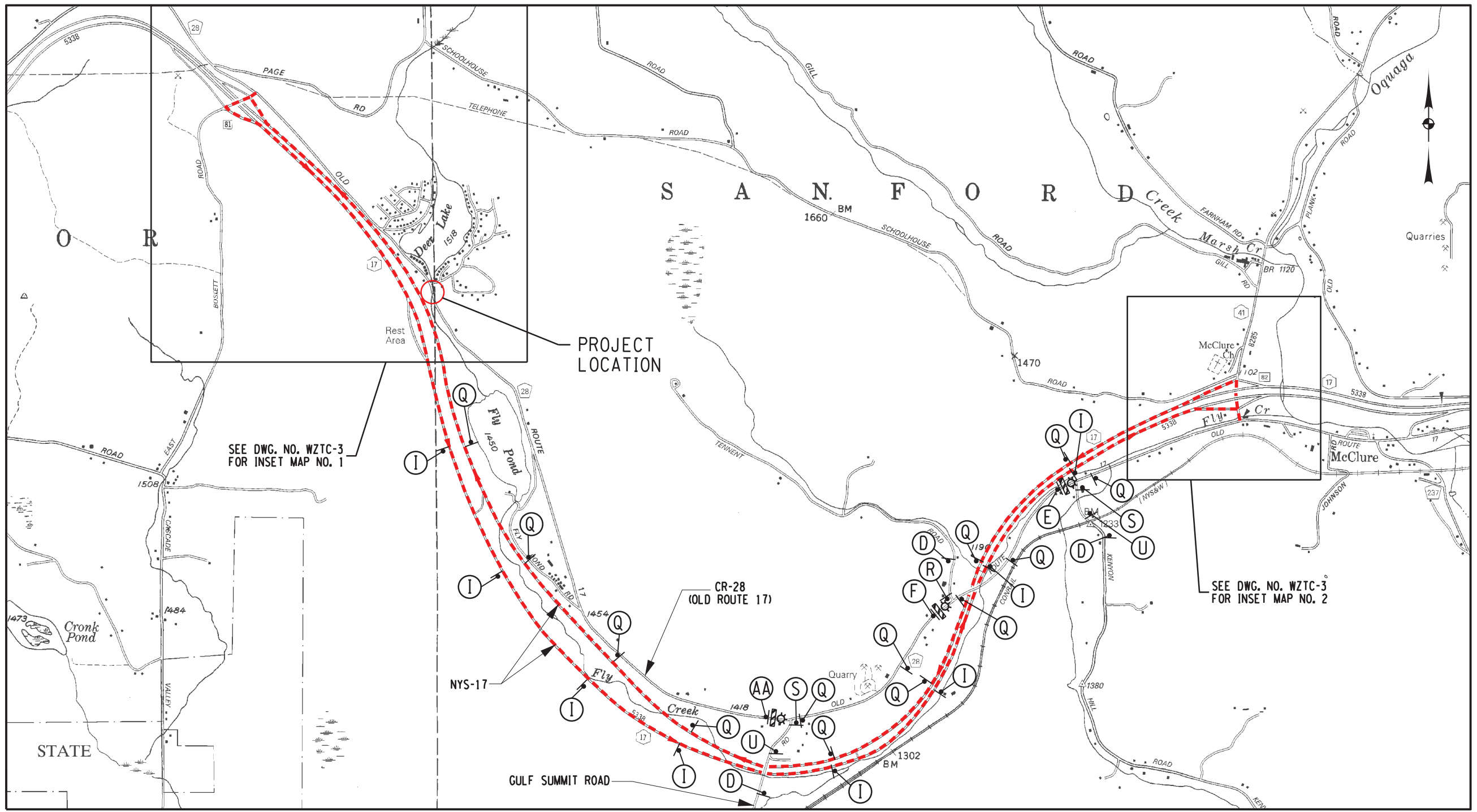

PREPARED BY: BARTON & LOGUIDICE, D.P.C.



**LEGEND:**

- SIGNS (N MUTCD), PAYMENT UNDER ITEM 619.01
- TYPE III CONSTRUCTION BARRICADE, WITH LIGHTING, ITEM 619.04
- DETOUR ROUTE

**NOTES:**

1. FOR ADDITIONAL INFORMATION, REFER TO NYS DOT STANDARD SHEET 619-503.
2. COVER ANY CONFLICTING SIGNS, PAYMENT UNDER ITEM 619.01.
3. R11-3b SIGNS SHALL BE INSTALLED ON THEIR OWN SIGN STANDS AT 5' MOUNTING HEIGHT, AND PLACED BEHIND THE TYPE III BARRICADE. (SIGN CAN BE LOCATED AT EDGE OF TRAVELED WAY).
4. SEE DWG. WZTC-4 FOR DETOUR SIGNFACE LAYOUTS.

CONFIRMATION SIGNS (I) (Q) SHALL BE REPEATED AT A MAXIMUM DISTANCE OF EVERY HALF MILE, IN ACCORDANCE WITH NYS DOT STANDARD SHEET 619-503. SIGNS ON PLAN ABOVE WHICH IS NOT TO SCALE, ARE FOR ILLUSTRATION PURPOSES ONLY.

							10 27
<b>Barton &amp; Loguidice</b> <small>UNAUTHORIZED ALTERATION OR ADDITION TO THIS DRAWING IS A VIOLATION OF THE NEW YORK STATE EDUCATION LAW ARTICLE 145 SECTION 7209</small>							
<b>BROOME COUNTY HIGHWAY DEPARTMENT</b>							
NO.	DATE	BY	REVISION				
OLD ROUTE 17 (CR 28) OVER FLY CREEK TOWN OF SANFORD BROOME COUNTY P.I.N. 9755.43							
WORK ZONE TRAFFIC CONTROL DETOUR PLAN							
SCALE: NONE							
DATE ISSUED: 03 / 2025							
DRAWING WZTC-2							

FILE NAME = I:\Projects\200\287 - Broome County\287.020 - Old Route 17\287.020-WZTC-3.dgn  
 DATE = 3/19/2025  
 TIME = 3:40:29 PM

MicroStation\Bentley V8\Workspace\Plot\WYSDOT\_SIZE\_B\_XEROX.tbl  
 MicroStation\Bentley V8\Workspace\System\plot.ctb

IN CHARGE OF WRB DESIGNED BY GRW/K/TR CHECKED BY WRB DRAFTED BY MEK/K/TR CHECKED BY WRB/GRW

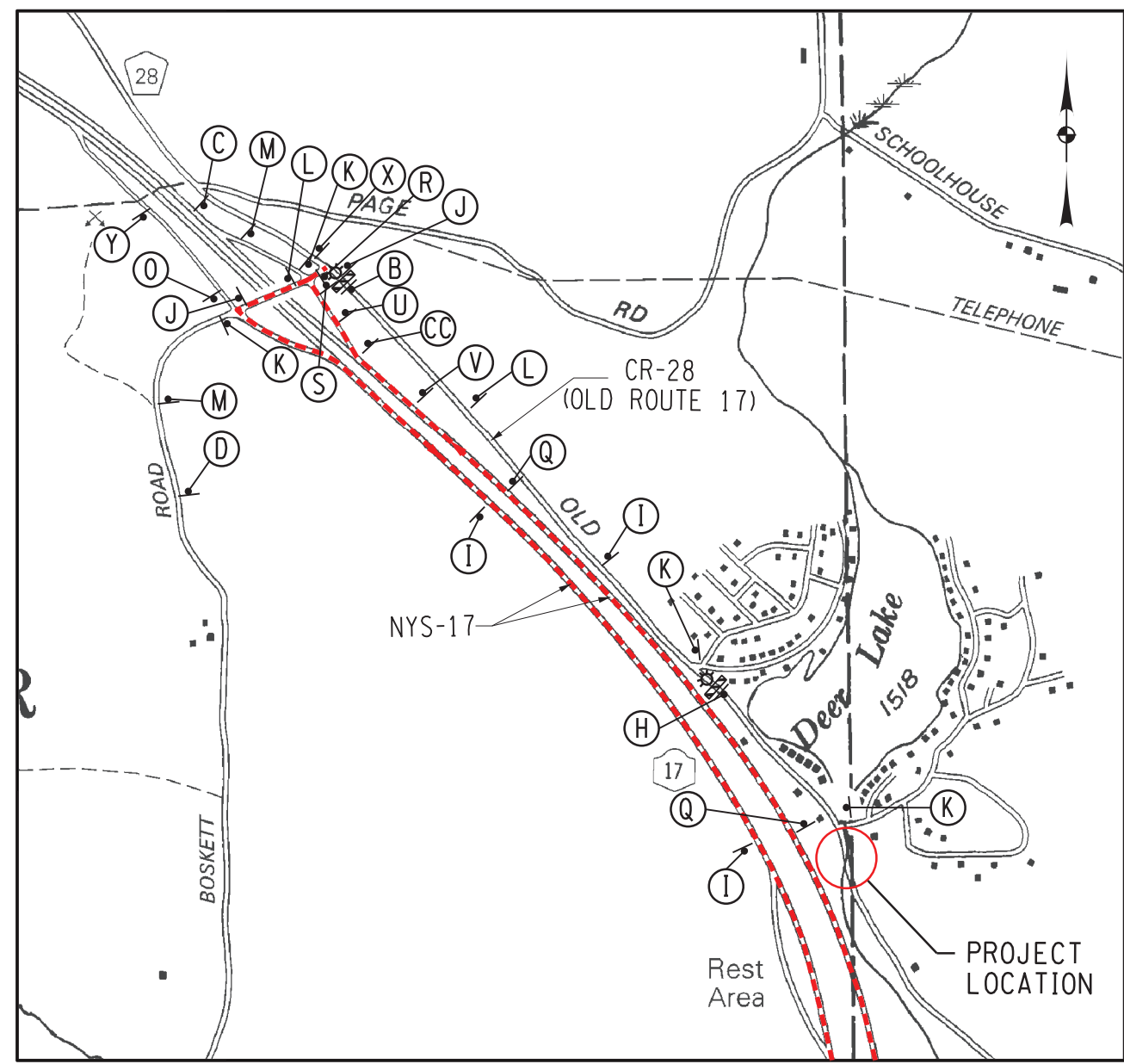

INSET MAP NO. 1  
NOT TO SCALE

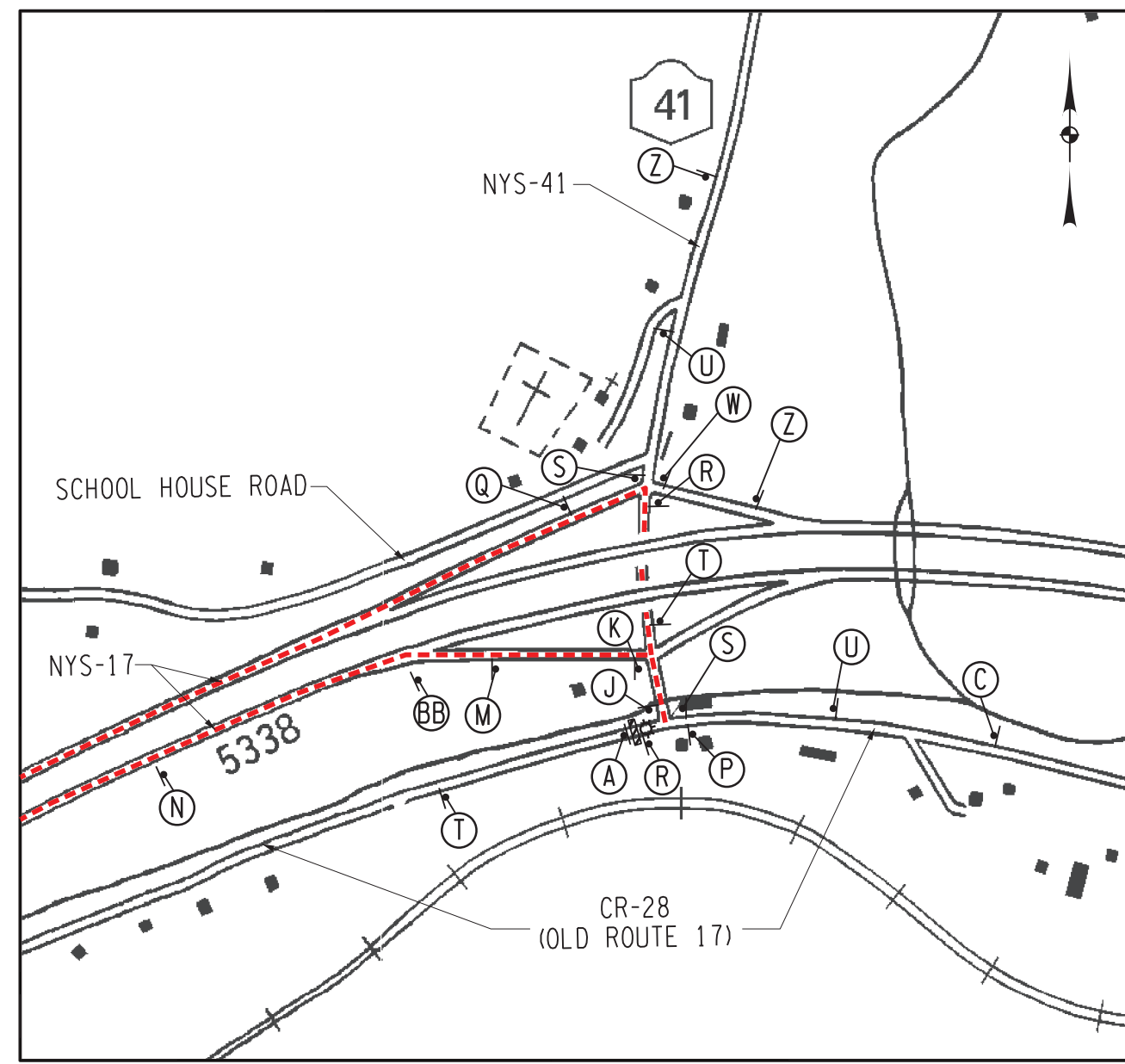

INSET MAP NO. 2  
NOT TO SCALE

CONFIRMATION SIGNS (I) (Q) SHALL BE REPEATED AT A MAXIMUM DISTANCE OF EVERY HALF MILE, IN ACCORDANCE WITH NYSDOT STANDARD SHEET 619-503. SIGNS ON PLAN ABOVE WHICH IS NOT TO SCALE, ARE FOR ILLUSTRATION PURPOSES ONLY.

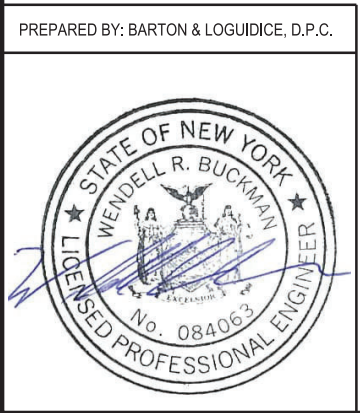

**LEGEND:**

- SIGNS (NMUTCD), PAYMENT UNDER ITEM 619.01
- TYPE III CONSTRUCTION BARRICADE, WITH LIGHTING, ITEM 619.04
- DETOUR ROUTE

**NOTES:**

1. FOR ADDITIONAL INFORMATION, REFER TO NYSDOT STANDARD SHEET 619-503.
2. COVER ANY CONFLICTING SIGNS, PAYMENT UNDER ITEM 619.01.
3. R11-3b SIGNS SHALL BE INSTALLED ON THEIR OWN SIGN STANDS AT 5' MOUNTING HEIGHT, AND PLACED BEHIND THE TYPE III BARRICADE, (SIGN CAN BE LOCATED AT EDGE OF TRAVELED WAY).
4. SEE DWG. WZTC-4 FOR DETOUR SIGNFACE LAYOUTS.

NO. / DATE	BY	REVISION	
<b>BROOME COUNTY</b> <b>HIGHWAY DEPARTMENT</b>			
UNAUTHORIZED ALTERATION OR ADDITION TO THIS DRAWING IS A VIOLATION OF THE NEW YORK STATE EDUCATION LAW ARTICLE 145 SECTION 7209			
OLD ROUTE 17 (CR 28) OVER FLY CREEK	TOWN OF SANFORD	BROOME COUNTY	P.I.N. 9755.43
<b>WORK ZONE</b> <b>TRAFFIC CONTROL</b> <b>DETOUR PLAN</b>			
SCALE: NONE			
DATE ISSUED: 03 / 2025			
DRAWING WZTC-3			

FILE NAME = I:\Projects\2007\287 - Broome County\287\_020 - Old Route 17\287\_020-WZTC-4.dgn  
 DATE = 3/19/2025  
 TIME = 3:40:30 PM

DETOUR SIGN TABLE

<p><b>A</b></p> <p>R11-3b (60"x30") M4-10R (48"x18") (SEE NOTE 4)</p>	<p><b>C</b></p> <p>W20-2 (36"x36")</p>	<p><b>Y</b></p> <p>EAST M3-2 (24"x12") BROOME COUNTY 28 M1-6 (24"x24") DETOUR AHEAD W20-2 (36"x36")</p>	<p><b>L</b></p> <p>DETOUR M4-8 (24"x12") EAST M3-2 (24"x12") BROOME COUNTY 28 M1-6 (24"x24") M5-1L (21"x15")</p>	<p><b>Q</b></p> <p>DETOUR M4-8 (24"x12") WEST M3-4 (24"x12") BROOME COUNTY 28 M1-6 (24"x24")</p>	<p><b>V</b></p> <p>DETOUR M4-8 (24"x12") WEST M3-4 (24"x12") BROOME COUNTY 28 M1-6 (24"x24") M5-2R (21"x15")</p>
<p><b>B</b></p> <p>R11-3b (60"x30") M4-10R (48"x18") (SEE NOTE 4)</p>	<p><b>D</b></p> <p>BROOME COUNTY 28 M1-6 (24"x24") DETOUR AHEAD W20-2 (36"x36")</p>	<p><b>Z</b></p> <p>WEST M3-4 (24"x12") BROOME COUNTY 28 M1-6 (24"x24") DETOUR AHEAD W20-2 (36"x36")</p>	<p><b>M</b></p> <p>DETOUR M4-8 (24"x12") EAST M3-2 (24"x12") BROOME COUNTY 28 M1-6 (24"x24") M5-1R (21"x15")</p>	<p><b>R</b></p> <p>DETOUR M4-8 (24"x12") WEST M3-4 (24"x12") BROOME COUNTY 28 M1-6 (24"x24") M6-1L (21"x15")</p>	<p><b>W</b></p> <p>DETOUR M4-8 (24"x12") WEST M3-4 (24"x12") BROOME COUNTY 28 M1-6 (24"x24") M6-3 (21"x15")</p>
<p><b>NOTES:</b></p> <ol style="list-style-type: none"> <li>SEE DWG. WZTC-2 &amp; WZTC-3 FOR DETOUR SIGN LOCATIONS.</li> <li>FOR ADDITIONAL INFORMATION, REFER TO NYS DOT STANDARD SHEET 619-503.</li> <li>COVER ANY CONFLICTING SIGNS, PAYMENT UNDER ITEM 619.01.</li> <li>R11-3b SIGNS SHALL BE INSTALLED ON THEIR OWN SIGN STANDS AT 5' MOUNTING HEIGHT, AND PLACED BEHIND THE TYPE III BARRICADE, (SIGN CAN BE LOCATED AT EDGE OF TRAVELED WAY).</li> <li>SIGNS A, B, E, F, AA, AND H SHALL BE PLACED AT INTERSECTION.</li> <li>PER NYS DOT STANDARD SHEET 619-503 NOTES ON SHEET 3 OF 3, SIGN GROUPINGS L, M, T, AND U SHALL ALWAYS BE POSTED A MAXIMUM OF 50' FROM AN INTERSECTION.</li> </ol>	<p><b>E</b></p> <p>R11-3b (60"x30") (SEE NOTE 4)</p>	<p><b>I</b></p> <p>DETOUR M4-8 (24"x12") EAST M3-2 (24"x12") BROOME COUNTY 28 M1-6 (24"x24") M5-2R (21"x15")</p>	<p><b>N</b></p> <p>DETOUR M4-8 (24"x12") EAST M3-2 (24"x12") BROOME COUNTY 28 M1-6 (24"x24") M6-1R (21"x15")</p>	<p><b>S</b></p> <p>DETOUR M4-8 (24"x12") WEST M3-4 (24"x12") BROOME COUNTY 28 M1-6 (24"x24") M6-1R (21"x15")</p>	<p><b>X</b></p> <p>END DETOUR M4-8a (24"x18") WEST M3-4 (24"x12") BROOME COUNTY 28 M1-6 (24"x24")</p>
<p>M3-2 M3-4 EAST WEST M1-6 BROOME COUNTY 28 M5-X</p>	<p><b>F</b></p> <p>R11-3b (60"x30") (SEE NOTE 4)</p>	<p><b>J</b></p> <p>DETOUR M4-8 (24"x12") EAST M3-2 (24"x12") BROOME COUNTY 28 M1-6 (24"x24") M6-1L (21"x15")</p>	<p><b>O</b></p> <p>DETOUR M4-8 (24"x12") EAST M3-2 (24"x12") BROOME COUNTY 28 M1-6 (24"x24") M6-3 (21"x15")</p>	<p><b>T</b></p> <p>DETOUR M4-8 (24"x12") WEST M3-4 (24"x12") BROOME COUNTY 28 M1-6 (24"x24") M5-1L (21"x15")</p>	<p><b>BB</b></p> <p>DETOUR M4-8 (24"x12") EAST M3-2 (24"x12") BROOME COUNTY 28 M1-6 (24"x24") M6-2R (21"x15")</p>
<p>ALL M1-6, M3-X, M5-X, AND M6-X ARROW SIGNS AND CARDINAL DIRECTION SIGNS SHALL BE YELLOW AND BLUE (TYP.)</p>	<p><b>AA</b></p> <p>R11-3b (60"x30") (SEE NOTE 4)</p>	<p><b>K</b></p> <p>DETOUR M4-8 (24"x12") EAST M3-2 (24"x12") BROOME COUNTY 28 M1-6 (24"x24") M6-1R (21"x15")</p>	<p><b>P</b></p> <p>END DETOUR M4-8a (24"x18") EAST M3-2 (24"x12") BROOME COUNTY 28 M1-6 (24"x24")</p>	<p><b>U</b></p> <p>DETOUR M4-8 (24"x12") WEST M3-4 (24"x12") BROOME COUNTY 28 M1-6 (24"x24") M5-1R (21"x15")</p>	<p><b>CC</b></p> <p>DETOUR M4-8 (24"x12") WEST M3-4 (24"x12") BROOME COUNTY 28 M1-6 (24"x24") M6-2R (21"x15")</p>
<p>PREPARED BY: BARTON &amp; LOGUIDICE, D.P.C.</p>	<p><b>H</b></p> <p>R11-3b (60"x30") (SEE NOTE 4)</p>				



<p>NO. / DATE / BY / REVISION</p>	
<p>BROOME COUNTY HIGHWAY DEPARTMENT</p>	
<p><b>Barton &amp; Loguidice</b></p> <p>UNAUTHORIZED ALTERATION OR ADDITION TO THIS DRAWING IS A VIOLATION OF THE NEW YORK STATE EDUCATION LAW ARTICLE 145 SECTION 7209</p>	
<p>OLD ROUTE 17 (CR 28) OVER FLY CREEK</p>	<p>TOWN OF SANFORD</p>
<p>BROOME COUNTY</p>	<p>P.I.N. 9755.43</p>
<p>WORK ZONE TRAFFIC CONTROL SIGNS</p>	
<p>SCALE: NONE</p>	
<p>DATE ISSUED: 03 / 2025</p>	
<p>DRAWING WZTC-4</p>	